

BUILDING SIGNAGE LEGEND AND NOTES:

- 1 - TACTILE EXIT SIGN (VISIBLE FROM ANY DIRECTION OF EGRESS TRAVEL, (SEE 120A-2.5))
- 2 - ACCESSIBLE ENTRANCE SIGN (SEE 600-6.6)
- 3 - OCCUPANCY SIGNAGE TO BE POSTED PER (CBC 100A.3)

EXIT - EXIT LIGHT W/ EMERGENCY LIGHTING AND BATTERY 90 MINUTE BACKUP
(REFER TO PERMITTED ELECTRICAL DRAWINGS FOR EMERGENCY LIGHTING REQUIREMENTS)

1. WHERE BOTH VISUAL AND TACTILE CHARACTERS ARE REQUIRED, EITHER ONE SIGN WITH BOTH VISUAL AND TACTILE CHARACTERS, OR TWO SEPARATE SIGNS, ONE WITH VISUAL AND ONE WITH TACTILE CHARACTERS, SHALL BE PROVIDED. (11B-703.1)

2. WHERE TACTILE SIGN IS PROVIDED AT DOOR, THE SIGN SHALL BE LOCATED ALONG THE DOOR AT THE LATCH SIDE. TACTILE CHARACTERS ON SIGN SHALL BE LOCATED 48" MIN. ABOVE FINISH FLOOR, MEASURED FROM THE BASELINE OF THE LOWEST BRAILLE CELLS AND A 90" MAX. ABOVE FINISH FLOOR, MEASURED FROM THE BASE LINE OF THE HIGHEST LINE OF THE RAISED CHARACTERS. (11B-703.4) (FIG 11B-703.4.1)

2 Building Signage
1/8" = 1'-0"

BUILDING NOTES:

1. THE CONSTRUCTION SHALL NOT RESTRICT A FIVE-FOOT CLEAR AND UNOBSTRUCTED ACCESS TO ANY WASTE OR POWER DISTRIBUTION FACILITIES (POWER POLES, PILLARBOXES, TRANSFORMERS, VALVES, PUMPS, VALVES, METERS, APPURTENANCES, ETC.) OR TO THE LOCATION OF THE HOODS/HUP. TACTILE CHARACTERS SHALL NOT BE WITHIN TEN FEET OF ANY POWER LINES/WHETHER OR NOT THE LINES ARE LOCATED ON THE PROPERTY. FAILURE TO COMPLY MAY CAUSE CONSTRUCTION DELAYS AND/OR ADDITIONAL EXPENSES.
2. EXIT SIGNS SHALL BE INTERNALLY OR EXTERNALLY ILLUMINATED.
3. EXIT SIGNS SHALL BE ILLUMINATED BY AN EXTERNAL SOURCE SHALL HAVE AN INTENSITY OF NOT LESS THAN 5 FOOT CANDLES (SAID).
4. INTERNALLY ILLUMINATED SIGNS SHALL BE LISTED AND LABELED AND SHALL BE INSTALLED IN ACCORDANCE WITH THE MANUFACTURER'S INSTRUCTION AND SECTION 2702.
5. EXIST SIGNS SHALL BE ILLUMINATED AT ALL TIMES.
6. EXIST SIGNS SHALL BE CONNECTED TO AN EMERGENCY POWER SYSTEM THAT WILL PROVIDE AN ILLUMINATION OF NOT LESS THAN 90 MIN. IN CASE OF PRIMARY POWER LOSS. THE EMERGENCY POWER SYSTEM SHALL PROVIDE POWER FOR A DURATION OF NOT LESS THAN 90 MINUTES AND SHALL CONSIST OF STORAGE BATTERIES, UNIT EQUIPMENT OR AN ON-SITE GENERATOR. THE INSTALLATION OF THE EMERGENCY POWER SYSTEM SHALL IN ACCORDANCE WITH SECTION 2702. (1011.6.3)
7. EGRESS DOORS SHALL BE READILY OPERABLE FROM THE EGRESS SIDE WITHOUT THE USE OF A KEY OR SPECIAL KNOWLEDGE OR EFFORT. SEE 1009.1.9. FOR EXCEPTIONS.
8. DOOR HANDLES LOCK AND OTHER OPERATION DEVICES SHALL BE INSTALLED AT A MIN. 34" AND A MAX. 48" ABOVE THE FINISHED FLOOR.
9. LABEL PLACED DIRECTLY ABOVE EGRESS DOORS: "THIS DOOR TO REMAIN UNLOCKED WHEN BUILDING IS OCCUPIED"
10. ALL EGRESS DOOR OPERATION SHALL ALSO COMPLY WITH SECTION 1009.1.8-1099.1.8.12.
11. AN EGRESS DOOR SHALL BE SET IN MOTION WHEN SUBJECTED TO A 30M FORCE. THE DOOR SHALL SWING TO THE FULLY OPEN POSITION WHEN AN OPENING FORCE NOT TO EXCEED 15 POUNDS IS APPLIED TO THE LATCH SIDE. CBC 1009.1.5.
12. THE OPENING FORCE FOR INTERIOR SIDE SWING DOORS WITHOUT CLOSERS SHALL NOT EXCEED 5 POUNDS. CBC 1009.1.5.
13. EMERGENCY LIGHTING FACILITIES SHALL BE ARRANGED TO PROVIDE INITIAL ILLUMINATION THAT IS AT LEAST AN AVERAGE OF 1 FOOT-CANDLE (11 lux) AND A MINIMUM AT ANY POINT OF 0.1 FOOT-CANDLE (1 lux) MEASURED ALONG THE PATH OF EGRESS AT FLOOR LEVEL. ILLUMINATION LEVELS SHALL BE PERMITTED TO DECLINE TO 0.5 FOOT-CANDLE (5 lux) AVERAGE AND A MINIMUM AT ANY POINT OF 0.06 FOOT-CANDLE (0.6 lux) AT THE END OF THE EMERGENCY LIGHTING TIME DURATION. A MAXIMUM-TO-MINIMUM ILLUMINATION UNIFORMITY RATION OF 40 TO 1 SHALL NOT BE EXCEEDED.
14. ADDITIONAL DIRECTIONAL EXIT SIGNAGE MAY BE REQUIRED BY THE CITY AT THE TIME OF FINAL INSPECTION.
15. WALL, FLOOR AND CEILING SHALL NOT EXCEED THE FLAME SPREAD CLASSIFICATIONS IN CBC TABLE 603.9.
16. A COMPLETE LISTING OF HAZARDOUS MATERIAL SHALL BE PROVIDED BY CONTRACTOR AND SHALL INCLUDE THE FOLLOWING INFORMATION (414.1.3 CBC):
 - a) MATERIAL CLASSIFICATION AS SHOWN IN TABLES 307.1(1) AND TABLE 307.1(2).
 - b) THE QUANTITIES OF EACH HAZARDOUS MATERIAL.
 - c) CLOSED OR OPEN SYSTEMS FOR EACH HAZARDOUS MATERIAL.
 - d) GROUP H OCCUPANCY CLASSIFICATION OF THE AREA OF BUILDING.
17. PLANS FOR MODIFICATIONS TO EXISTING FIRE PROTECTION EQUIPMENT SUCH AS STANDPIPES, SPRINKLER SYSTEMS AND FIRE ALARMS SYSTEMS, SHALL BE SUBMITTED TO THE FIRE BUILDING DIVISION AND APPROVED BY THE FIRE DEPARTMENT BEFORE THIS EQUIPMENT IS ALTERED OR MODIFIED.
18. WHERE COMBUSTIBLE CONSTRUCTION OCCURS, FIRE BLOCKING MUST BE PROVIDED IN ACCORDANCE WITH SECTION 718.2 AT THE FOLLOWING LOCATIONS:
 - a) IN CONCEALED SPACES OF STUD WALLS AND PARTITIONS, INCLUDING FURRED SPACES.
 - b) AT 16-FOOT INTERVALS ALONG THE LENGTH OF THE WALL.
 - c) AT ALL INTERCONNECTIONS BETWEEN CONCEALED VERTICAL AND HORIZONTAL SPACES SUCH AS OCCURS AT SLOTTES, DROP CEILING AND COVE CEILING.
 - d) IN OPENINGS AROUND VENTS, PIPES, DUCTS, CHIMNEYS, FIRE PLACES AND SIMILAR OPENINGS WHICH AFFORD A PASSAGE FOR FIRE AT CEILING AND FLOOR LEVELS, WITH NONCOMBUSTIBLE MATERIALS.
 - e) CURTAINS, DRAPERIES, FABRIC HANGINGS AND SIMILAR COMBUSTIBLE DECORATIVE MATERIALS SUSPENDED FROM WALLS OR CEILING SHALL COMPLY WITH SECTION 607.4 AND SHALL NOT EXCEED 10 PERCENT OF THE SPECIFIC WALL OR CEILING AREA TO WHICH SUCH MATERIALS ARE ATTACHED.
19. EGRESS DOORS SHALL BE READILY OPERABLE FROM THE EGRESS SIDE WITHOUT THE USE OF A KEY OR SPECIAL KNOWLEDGE OR EFFORT. BUILDING CODE 101.1.9.
20. A TYPE 1 HOOD SHALL BE INSTALLED AT OR ABOVE ALL COMMERCIAL COOKING APPLIANCES AND DOMESTIC COOKING APPLIANCES USED FOR COMMERCIAL PURPOSES THAT PRODUCE GREASE VAPORS. FIRE CODE 909.2 AND BUILDING CODE 904.2.3.
21. STORAGE OF COOKING OIL (GREASE) IN COMMERCIAL COOKING OPERATIONS UTILIZING ABOVE-GROUND TANKS WITH A CAPACITY GREATER THAN 60 GAL (227 L) INSTALLED WITHIN A BUILDING SHALL COMPLY WITH SECTIONS 910.2 THROUGH 910.7 AND WPPA 30. FOR PURPOSES OF THIS SECTION, COOKING OIL SHALL BE CLASSIFIED AS CLASS BB LIQUID UNLESS OTHERWISE DETERMINED BY TESTING.
22. ADDRESS IDENTIFICATION: NEW AND EXISTING BUILDINGS SHALL BE PROVIDED WITH APPROVED ADDRESS IDENTIFICATION. THE ADDRESS IDENTIFICATION SHALL BE LEGIBLE AND PLACED IN A POSITION THAT IS VISIBLE FROM THE STREET OR ROAD FRONTING THE PROPERTY. ADDRESS IDENTIFICATION CHARACTERS SHALL CONTRAST WITH THEIR BACKGROUND. ADDRESS NUMBERS SHALL BE ARABIC NUMBERS OR ALPHABETICAL LETTERS. NUMBERS SHALL NOT BE SPED OUT. EACH CHARACTER SHALL BE A MINIMUM OF 4 INCHES (102 mm) HIGH WITH A MINIMUM STROKE WIDTH OF 1/2 INCH (12.7 mm), WHERE REQUIRED BY THE FIRE CODE. OFFICIAL ADDRESS IDENTIFICATION SHALL BE PROVIDED IN ADDITIONAL APPROVED LOCATIONS TO FACILITATE EMERGENCY RESPONSE, WHERE ACCESS IS BY MEANS OF A PRIVATE ROAD AND THE BUILDING ADDRESS CANNOT BE VIEWED FROM THE PUBLIC WAY. A MONUMENT POLE, OR OTHER APPROVED SIGN OR MEANS SHALL BE USED TO IDENTIFY THE STRUCTURE. ADDRESS IDENTIFICATION SHALL BE MAINTAINED.

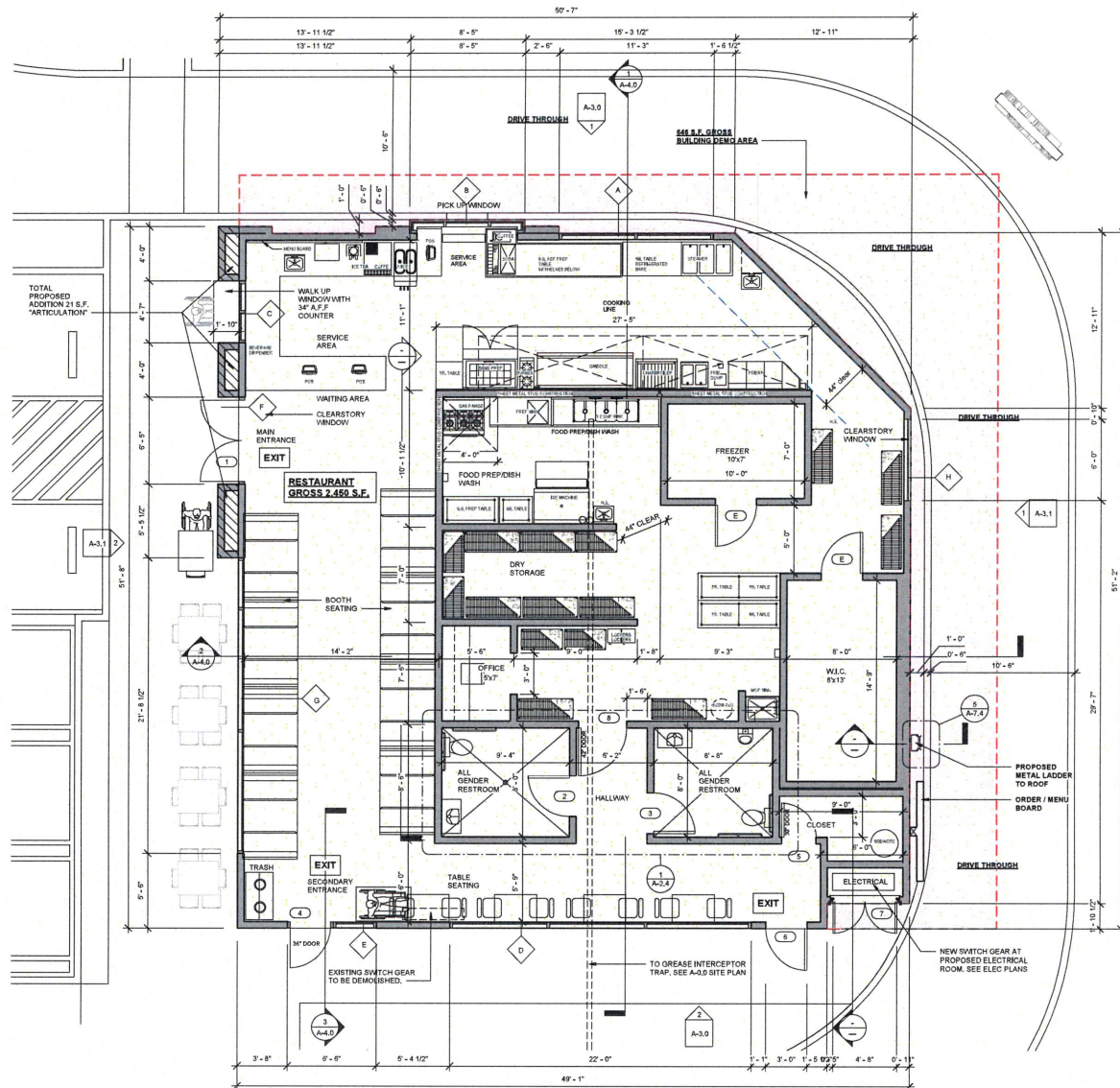

1 First Floor
1/4" = 1'-0"

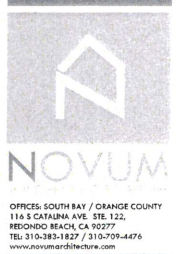

TOM'S JR
1439 E EDINGER AVE. SANTA ANA, CA 92705
Mr. Spiros Politis

No.	Description	Date

Proposed Floor Plan



Project Number tom's2023
Date 2-13-2024
Drawn By Author
Checked By Checker

A-2.1

Scale As indicated