

RECORDING REQUESTED BY  
AND WHEN RECORDED MAIL TO:  
City of Santa Ana  
20 Civic Center Plaza (M-30)  
Santa Ana, CA 92702  
Attn: Clerk of the Council

FREE RECORDING PURSUANT TO GOVERNMENT CODE § 27383

---

## HISTORIC PROPERTY PRESERVATION AGREEMENT

This Historic Property Preservation Agreement (“Agreement”) is made and entered into by and between the City of Santa Ana, a charter city and municipal corporation duly organized and existing under the Constitution and laws of the State of California (hereinafter referred to as “City”), and **Brent A. Ferdig, a single man**, (hereinafter collectively referred to as “Owner”), owner of real property located at **2010 Greenleaf Street, Santa Ana, California**, in the County of Orange and listed on the Santa Ana Register of Historical Properties.

### RECITALS

- A. The City Council of the City of Santa Ana is authorized by California Government Code Section 50280 et seq. (known as the “Mills Act”) to enter into contracts with owners of qualified historical properties to provide for appropriate use, maintenance, rehabilitation and restoration such that these historic properties retain their historic character and integrity.
- B. The Owner possesses fee title in and to that certain qualified real property together with associated structures and improvements thereon, located at **2010 Greenleaf Street, Santa Ana, CA, 92706** and more particularly described in Exhibit “A,” attached hereto and incorporated herein by reference, and hereinafter referred to as the “Historic Property”.
- C. The Historic Property is officially designated on the Santa Ana Register of Historical Properties pursuant to the requirements of Chapter 30 of the Santa Ana Municipal Code.
- D. City and Owner, for their mutual benefit, now desire to enter into this Agreement which defines and limits the use and alteration of this Historic Property in order to enhance and maintain its value as a cultural and historical resource for Owner and for the community; to prevent inappropriate alterations to the Historic Property and to ensure that repairs, additions, new building, and other changes are appropriate; and to ensure that rehabilitation and maintenance are carried out in an exemplary manner.
- E. Owner and City intend to carry out the purposes of California Government Code, Chapter 1, Part 5 of Division 1 of Title 5, Article 12, Section 50280 et seq., which

will enable the Historic Property to qualify for an assessment of valuation as a restricted historical property pursuant to Article 1.9, Sec. 439 et seq., Chapter 3 Part 2 of Division 1 of the California Tax and Revenue Code.

NOW, THEREFORE, the City of Santa Ana and the Owner of the Historic Property agree as follows:

**1. Effective Date and Terms of Agreement.**

This Agreement shall be effective and commence on **June 22, 2022**, and shall remain in effect for a term of ten (10) years thereafter. Each year, upon the anniversary of the effective date of this Agreement, such initial term will automatically be extended as provided in California Government Code Sections 50280 through 50290 and in Section 2, below.

**2. Renewal.**

a. Each year on the anniversary of the effective date of this Agreement, a year shall automatically be added to the initial ten (10) year term of this Agreement unless written notice of nonrenewal is served as provided herein.

b. If the Owner or the City desire(s) in any year not to renew the Agreement, the Owner or City shall serve written notice of nonrenewal of the Agreement on the other party. Unless such notice is served by the Owner to the City at least ninety (90) days prior to the annual renewal date, or served by the City to the Owner at least sixty (60) days prior to the annual renewal date, one (1) year shall automatically be added to the term of the Agreement as provided herein.

c. Within 30 days from receipt of City's notice of nonrenewal, the Owner may file a written protest of City's decision of nonrenewal. The City may, at any time prior to the annual renewal date of the Agreement, withdraw its notice to the Owner of nonrenewal.

d. If either the Owner or the City serves notice to the other of nonrenewal in any year, the Agreement shall remain in effect for the balance of the term then remaining, either from its original execution or from the last renewal of the Agreement, whichever may apply.

**3. Standards and Conditions for Historic Property.**

During the term of this Agreement, the Historic Property shall be subject to the following conditions, requirements and restrictions:

a. Owner shall maintain the Historic Property in a good state of repair and shall preserve, maintain, and, where necessary, restore or rehabilitate the property and its character-defining features described in the "Historical Property Description" attached hereto, marked as Exhibit B, notably the general architectural form, style, materials, design, scale, proportions, organization of windows, doors, and other openings, textures, details, mass, roof line, porch and other aspects of the appearance of the exterior to the satisfaction of the City.

b. All changes to the Historic Property shall comply with applicable City plans and regulations, and conform to the rules and regulations of the Office of Historic Preservation of the State Department of Parks and Recreation, namely the U.S. Secretary of the Interior's Standards and Guidelines for Historic Preservation Projects. These guidelines are attached hereto, marked as Exhibit C, and incorporated herein by this reference. Owner shall continually maintain the Historic Property in the same or better condition.

c. A view corridor enabling the general public to see the Historic Property from the public right-of-way shall be maintained, and Owner shall not be permitted to block the view corridor to the property with any new structure, such as walls, fences or shrubbery, so as to prevent the viewing of the historic landmark by the public.

d. The following are prohibited: demolition of the Historic Property or destruction of character-defining features of the building or site; removal of trees and other major vegetation unless removal is approved by a rehabilitation plan approved by the Historic Resources Commission; paving of yard surface; exterior alterations or additions unless approved by the Historic Resources Commission and such alterations are in keeping with the Secretary of Interior's Standards; deteriorating, dilapidated or unrepaired structures such as fences, roofs, doors, walls, and windows; storage of junk, trash, debris, discarded or unused objects such as cars, appliances, or furniture; and other unsightly by decoration, structure or vegetation which is unsightly by reason of its height, condition, or inappropriate location.

e. Owner shall allow reasonable periodic inspection by prior appointment, as needed or at least every five (5) years after the initial inspection, of the interior and exterior of the Historic Property by representatives of the City of Santa Ana, the County Assessor, the State Department of Parks and Recreation, and the State Board of Equalization, to determine the Owner's compliance with the terms and provisions of this Agreement.

#### **4. Furnishing of Information.**

The Owner hereby agrees to furnish the City with any and all information requested which may be necessary or advisable to determine compliance with the terms and provisions of this Agreement.

#### **5. Cancellation.**

a. The City, following a duly noticed public hearing by the City Council as set forth in Government Code Section 50280, et. seq., may cancel this Agreement if it determines that the Owner have breached any of the conditions of this Agreement, or has allowed the property to deteriorate to the point that it no longer meets the standards for a qualified Historic Property, or if the City determines that the Owner have failed to restore or rehabilitate the property in the manner specified in Section 3 of this Agreement. If a contract is cancelled for these reasons, the Owner shall pay a cancellation fee to the County Auditor as set forth in Government Code Section 50286. This cancellation fee shall be a percentage (currently set at twelve and one-half (12 ½) percent by Government Code Section 50286) of the current fair market value of the

property at the time of the cancellation, as determined by the county assessor, without regard to any restriction imposed pursuant to this Agreement.

b. If the Historic Property is destroyed by earthquake, fire, flood or other natural disaster such that in the opinion of the City Building Official more than sixty (60) percent of the original fabric of the structure must be replaced, this Agreement shall be canceled immediately because, in effect, the historic value of the structure will have been destroyed. No fee shall be imposed in the case of destruction by acts of God or natural disaster.

c. If the Historic Property is acquired by eminent domain and the City Council determines that the acquisition frustrates the purpose of this Agreement, this Agreement shall be cancelled and no fee imposed, as specified in Government Code Section 50288.

## **6. Enforcement of Agreement.**

a. In lieu of and/or in addition to any provisions to cancel the Agreement as referenced herein, City may specifically enforce, or enjoin the breach of, the terms of the Agreement. In the event of a default, under the provisions to cancel the Agreement by Owner, the City shall give written notice to Owner by registered or certified mail, and if such a violation is not corrected to the reasonable satisfaction of the City Manager or designee within thirty (30) days thereafter, or if not corrected within such a reasonable time as may be required to cure the breach or default, or default cannot be cured within thirty (30) days (provided that acts to cure the breach or default may be commenced within thirty (30) days and shall thereafter be diligently pursued to completion by Owner), then City may, without further notice, declare a default under the terms of this Agreement and may bring any action necessary to specifically enforce the obligations of Owner growing out of the terms of this Agreement, apply to any court, state or federal, for injunctive relief against any violation by Owner or apply for such relief as may be appropriate.

b. City does not waive any claim of default by the Owner if City does not enforce or cancel this Agreement. All other remedies at law or in equity which are not otherwise provided for in this Agreement or in City's regulations governing historic properties are available to City to pursue in the event that there is a breach of this Agreement. No waiver by City of any breach or default under this Agreement shall be deemed to be a waiver of any other subsequent breach thereof or default hereunder.

## **7. Binding effect of Agreement.**

a. Owner hereby subjects the Historic Property, located at **2010 Greenleaf Street**, Assessor Parcel Number, **002-091-02**, and more particularly described in Exhibit A, in the City of Santa Ana, to the covenants, conditions, and restrictions as set forth in this Agreement.

b. City and Owner hereby declare their specific intent that the covenants, conditions and restrictions as set forth herein shall be deemed covenants running with the land and shall pass to and be binding upon Owner's successors and assigns in title or interest to the Historic Property. Every contract, deed, or other instrument hereinafter executed, covering or conveying

the Historic Property or any portion thereof, shall conclusively be held to have been executed, delivered, and accepted subject to the tenants, restrictions, and reservations expressed in this Agreement regardless of whether such covenants, conditions and restrictions are set forth in such contract, deed, or other instrument.

**8. No Compensation.**

Owner shall not receive any payment from City in consideration of the obligation imposed under this Agreement, it being recognized that the consideration for the execution of this Agreement is the substantial public benefit to be derived therefrom and the advantage that will accrue to Owner as a result of the effect upon the assessed value of the Property on the account of the restrictions on the use and preservation of the Property.

**9. Notice.**

Any notice required by the terms of this Agreement shall be sent to the address of the respective parties as specified below or at other addresses that may be later specified by the parties hereto.

City: City of Santa Ana  
20 Civic Center Plaza (M-30)  
Santa Ana, CA 92702  
Attn: Clerk of the Council

Owners: Brent A. Ferdig  
2010 Greenleaf Street  
Santa Ana, CA 92706

**10. General Provisions.**

a. None of the terms, provisions, or conditions of this Agreement shall be deemed to create a partnership between the parties hereto and any of their heirs, successors, or assigns, nor shall such terms, provisions or conditions cause them to be considered joint ventures or members of any joint enterprise.

b. The Owner agrees to and shall indemnify and hold the City and its elected and appointed officials, officers, agents, and employees harmless from liability for damage or claims for damage for personal injuries, including death, and claims for property damage which may arise from the direct or indirect use or operations of the Owner or those of his or her contractor, subcontractor, agent, employee, or other person acting on his or her behalf which relates to the use, operation, and maintenance of the Historic Property. The Owner hereby agrees to and shall defend the City and its elected and appointed officials, officers, agents, and employees with respect to any and all actions for damages caused by, or alleged to have been caused by, reason of the Owner's activities in connection with the Historic Property.

c. This hold harmless provision applies to all damages and claims for damages suffered, or alleged to have been suffered, and costs of defense incurred, by reason of the operations referred to in this Agreement regardless of whether or not City prepared, supplied, or approved the plans, specifications or other documents for the Historic Property.

d. All of the agreements, rights, covenants, conditions, and restrictions contained in this Agreement shall be binding upon and shall inure to the benefit of the parties herein, their heirs, successors, legal representatives, assigns, and all persons acquiring any part or portion of the Historic Property, whether by operation of law or in any manner whatsoever.

e. In the event legal proceedings are brought by any party or parties to enforce or restrain a violation of any of the covenants, reservations, or restrictions contained herein, or to determine the rights and duties of any party hereunder, the prevailing party in such proceeding may recover all reasonable attorney's fees to be fixed by the court, in addition to court costs and other relief ordered by the court.

f. In the event that any of the provisions of this Agreement are held to be unenforceable or invalid by any court of competent jurisdiction, or by subsequent preemptive legislation, the validity and enforceability of the remaining provisions, or portions thereof, shall not be effected thereby.

g. This Agreement shall be construed and governed in accordance with the laws of the State of California, with venue in Orange County.

#### **11. Recordation.**

No later than twenty (20) days after the parties execute and enter into this Agreement, the City shall cause this Agreement to be recorded in the office of the County Recorder of the County of Orange.

#### **12. Amendments.**

This Agreement may be amended, in whole or in part, only by a written recorded instrument executed by the parties hereto.

#### **13. Effective Date**

This Agreement shall be effective on the day and year first written above in Section 1.

{ Signature page follows }

**ATTEST:**

**CITY OF SANTA ANA**

\_\_\_\_\_  
DAISY GOMEZ  
Clerk of the Council

\_\_\_\_\_  
KRISTINE RIDGE  
City Manager

**OWNER**

Date: \_\_\_\_\_

By: \_\_\_\_\_  
BRENT A. FERDIG

**APPROVED AS TO FORM:**

SONIA CARVALHO  
City Attorney

**RECOMMENDED FOR APPROVAL:**

By: John M. Funk  
JOHN M. FUNK  
Assistant City Attorney

\_\_\_\_\_  
MINH THAI  
Executive Director  
Planning and Building Agency

**EXHIBIT A  
LEGAL DESCRIPTION**

ALL THAT CERTAIN REAL PROPERTY SITUATED IN THE COUNTY OF ORANGE,  
STATE OF CALIFORNIA, DESCRIBED AS FOLLOWS:

LOT 10 OF TRACT 813 AS SHOWN ON A MAP RECORDED IN BOOK 25, PAGE 3 OF  
MISCELLANEOUS MAPS, RECORDS OF ORANGE COUNTY, CA (THE "PROPERTY").

**Assessor's Parcel Number: 002-091-02**



# EXECUTIVE SUMMARY

Exhibit B

**Campbell-Jeffrey House**  
**2010 Greenleaf Street**  
**Santa Ana, CA 92706**

NAME	Campbell-Jeffrey House			REF. NO.
ADDRESS	2010 Greenleaf Street			
CITY	Santa Ana	ZIP	92706	ORANGE COUNTY
YEAR BUILT	1928	LOCAL REGISTER CATEGORY: Contributive		
HISTORIC DISTRICT	N/A	NEIGHBORHOOD	Floral Park	
CALIFORNIA REGISTER CRITERIA FOR EVALUATION	C/3	CALIFORNIA REGISTER STATUS CODE	5S3	

Location: ☐ Not for Publication ☒ Unrestricted

☐ Prehistoric ☒ Historic ☐ Both

## **ARCHITECTURAL STYLE:** Tudor Revival

The Tudor Revival looked to medieval England for its inspiration. Signature features of the style include steeply pitched gables; decorative half-timbering; arched openings, often Tudor or Gothic in form; asymmetrical arrangements of building features; tall brick chimneys; and picturesque windows of leaded glass or diamond patterned lights. The more ambitious examples of the Tudor Revival were executed in brick or even stone; however, stucco over wood frame is quite common in the forgiving climate of southern California. The Tudor Revival was favored primarily for residential buildings, although small scale commercial buildings in the style also occur. Originating in the late 19th century, the Tudor Revival was associated with some Craftsman era building but was most popular during the 1920s and 1930s.

## **SUMMARY/CONCLUSION:**

The Campbell-Jeffrey House qualifies for listing in the Santa Ana Register of Historical Properties under Criterion 1 as a representative and intact example of a Tudor Revival home. Additionally, the house has been categorized as "Contributive" because it "contributes to the overall character and history" of the Floral Park neighborhood and "is a good example of period architecture," representing the Tudor Revival style in Santa Ana (Santa Ana Municipal Code, Section 30-2.2).

## **EXPLANATION OF CODES:**

- California Register Criteria for Evaluation: (From California Office of Historic Preservation, Technical Assistance Series # 7, "How to Nominate Resources to the California Register of Historical Resources," September 4, 2001.)
  - 3:** It embodies the distinctive characteristics of a type, period, region, or method of construction, or represents the work of a master, or possesses high artistic values
- It embodies the distinctive characteristics of a type, period, region, or method of construction, or represents the work of a master, or possesses high artistic values.
  - 5S3:** Appears to be individually eligible for local listing or designation through survey evaluation

PRIMARY RECORD

Primary # \_\_\_\_\_  
HRI # \_\_\_\_\_  
Trinomial \_\_\_\_\_  
NRHP Status Code \_\_\_\_\_

Other Listings \_\_\_\_\_  
Review Code \_\_\_\_\_ Reviewer \_\_\_\_\_ Date \_\_\_\_\_

Page 1 of 3 Resource name(s) or number (assigned by recorder) *Campbell-Jeffrey House*

P1. Other Identifier:

\*P2. Location: ☐ Not for Publication ☒ Unrestricted

\*b. USGS 7.5' Quad TCA 1725

\*c. Address 2010 Greenleaf Street

\*e. Other Locational Data: Assessor's Parcel Number 002-091-02

\*a. County Orange County

Date: March 3, 2015

City Santa Ana

Zip 92706

\*P3a. Description: (Describe resource and its major elements. Include design, materials, condition, alterations, size, setting, and boundaries)

*Located in Floral Park, the Campbell-Jeffrey House is a one-story, single-family, residential building constructed in the Tudor Revival style. Asymmetrical in design, the house exhibits a complex hipped and gabled roof with a fairly steep pitch, incorporating a side-gabled body with a projecting front gable, covered in composition shingle roofing. The exterior of the building is clad with stucco and enlivened by decorative half-timbering that suggests a gothic arch. The primary (east) elevation is L-shaped, defined by the primary, projecting, front-gabled wing and a side-gabled wing setback approximately fifteen feet. A front-facing gablet projects from the side gable. Multi-light casement windows framed by white wooden shutters are centered below each front gable. Wing walls extend from either side of the front-gabled wing (north and south) towards two low porch walls with wooden pedestrian gates, one leading towards the front entry (south) and the second enclosing an uncovered front patio area (north). The front patio is further defined by an exterior, tapered, brick chimney extending above the roofline, half clad in stucco and capped by a course of bricks. The main entrance is located on the side (south) elevation and is arched and recessed within a gabled projection. The entryway is characterized by an original wood front door with an arched design, accessed via an entrance stoop and front porch walkway paved with non-original flat stone. A rear wing, topped by a hipped roof, terminates west end of the south elevation. Fenestration on the side and rear elevations consists of multi-light casement windows and nine-over-one double-hung wood windows, each shaded with black fabric awnings with wrought iron spear supports. The property appears to be substantially intact, although a pair of double-hung sash windows further to rear on the south elevation indicate that the attic has been converted to living space. The driveway is located along the south elevation and leads to the detached, one-story, two-car garage, which is front-gabled and also clad in stucco.*

\*P3b. Resource Attributes: (list attributes and codes) HP2. Single-Family Residence

\*P4. Resources Present: ☒ Building ☐ Structure ☐ Object ☐ Site ☐ District ☒ Element of District ☐ Other

P5a. Photo



P5b. Photo: (view and date)

East elevation, view west  
February 2022

\*P6. Date Constructed/Age and

Sources: ☒ historic

1928/ City of Santa Ana Building  
Permits

\*P7. Owner and Address:

Brent Ferdig  
2010 Greenleaf Street  
Santa Ana, CA 92706

\*P8. Recorded by:

Pedro Gomez  
20 Civic Center Plaza M-20  
Santa Ana, CA 92702

\*P9. Date Recorded:

May 5, 2022

\*P10. Survey Type:

Intensive Survey Update

\*P11. Report Citation: (Cite survey  
report and other sources, or enter "none")  
None

\*Attachments: ☐ None ☐ Location Map ☐ Sketch Map ☒ Continuation Sheet ☒ Building, Structure, and Object Record  
☐ Archaeological Record ☐ District Record ☐ Linear Feature Record ☐ Milling Station Record ☐ Rock Art Record  
☐ Artifact Record ☐ Photograph Record ☐ Other (list)

**BUILDING, STRUCTURE, AND OBJECT RECORD**

Page 2 of 3

\*NRHP Status Code 5S3

\*Resource Name or #: *Campbell-Jeffrey House*

B1. Historic Name: *Campbell-Jeffrey House*

B2. Common Name: *Same*

B3. Original Use: *Single-Family Residence*

B4. Present Use: *Single-Family Residence*

\*B5. Architectural Style: *Tudor Revival*

\*B6. Construction History: (Construction date, alterations, and date of alterations): *September 29, 1928. Constructed. \$6,500.*

*May 21, 1990. Reroof residence. \$7,800.*

*April 28, 2000. Reroof detached garage. \$2,400.*

*February 4, 2008. Build thirteen foot high fireplace in rear yard. \$7,000.*

\*B7. Moved? ☒ No ☐ Yes ☐ Unknown Date: \_\_\_\_\_ Original location: \_\_\_\_\_

\*B8. Related Features: *Detached Garage.*

B9a. Architect: *Unknown*

b. Builder: *Unknown*

\*B10. Significance: Theme *Residential architecture*

Area *Santa Ana*

Period of Significance: *1928*

Property Type: *Single-Family Residence*

Applicable Criteria: *C/3*

(Discuss importance in terms of historical or architectural context as defined by theme, period, and geographic scope. Also address integrity)

*The Campbell-Jeffrey House is architecturally significant as a characteristic example of the Tudor Revival architectural style. It was built in 1928 for \$6,500 by an unknown builder for D.W. Campbell. D.W. Campbell was the former Assistant City Treasurer (succeeded by Herbert P. Klotzly, was the general manager of the Southern Pacific in Los Angeles, and headed the panel of the Rationing Board. D.W. Campbell resided on the property for two years before selling the property to Mrs. Mary Jeffrey. Mrs. Jeffrey was considered an Orange County pioneer, along with her late husband William Jeffrey who passed away in 1921. They were both prominent in the growth and progress of the community, since they arrived in Orange County in 1897. Both Mr. and Mrs. Jeffrey were born in Scotland. They came to California from Edinburgh and settled first in Antelope Valley in 1884. When they came to Orange County in 1897, they bought a ranch home in Irvine where they lived many years. They had six children, including a former Orange County supervisor, George Jeffrey. Mrs. Mary Jeffrey passed away in her home on December 6, 1938 at the age of 83. After Mrs. Jeffrey's passing, the property was vacant for a year, then sold to P.A. Hodapp in 1940, who resided on the property until 1945. The property was sold in 1945 to L.H. Sheay who resided in the property until the late 1960s. Little information is available regarding occupancy of the residence from 1960-2000s. Since early 2000, the Campbell-Jeffrey House has been occupied by various owners until the current homeowners purchased the home in 2020.*

(See Continuation Sheet 3 of 3.)

B11. Additional Resource Attributes: (List attributes and codes)

\*B12. References:

*City of Santa Ana Building Permits*

*Santa Ana History Room Collection, Santa Ana Public Library*

*Sanborn Maps*

(See Continuation Sheet 3 of 3.)

B13. Remarks:

\*B14. Evaluator: *Leslie Heumann/Chattel Inc.*

\*Date of Evaluation: *May 5, 2022*

(This space reserved for official comments.)

Sketch Map

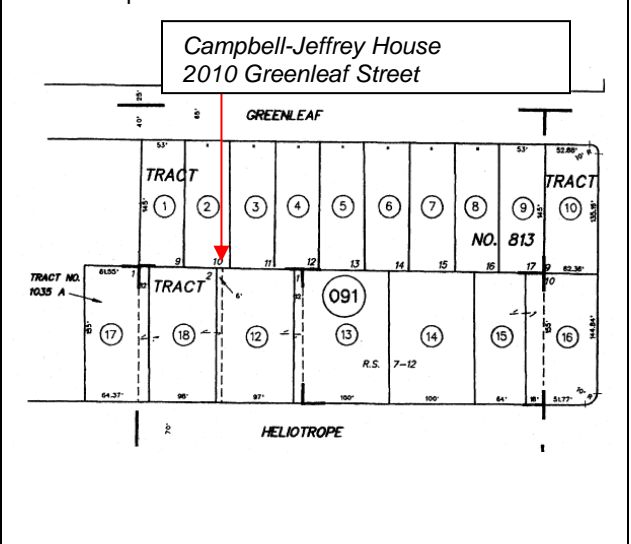

State of California — The Resources Agency  
DEPARTMENT OF PARKS AND RECREATION  
**CONTINUATION SHEET**

Primary # \_\_\_\_\_  
HRI # \_\_\_\_\_  
Trinomial \_\_\_\_\_

Page 3 of 3

Resource Name: *Campbell-Jeffrey House*

\*Recorded by *Pedro Gomez*

\*Date *May 5, 2022* ☒ Continuation ☐ Update

**\*B10. Significance (continued):**

*The Campbell-Jeffrey House is located in Floral Park, a neighborhood northwest of downtown Santa Ana bounded by West Seventeenth Street, North Flower Street, Riverside Drive, and Broadway. Groves of orange, avocado, and walnut trees and widely scattered ranch houses characterized this area before 1920. Developer and builder Allison Honer (1897-1981), credited as the subdivider and builder of a major portion of northwest Santa Ana, arrived in Santa Ana from Beaver Falls, New York in 1922 (Talbert, pages 353-356). "Before nightfall on the day of his arrival, Mr. Honer purchased a parcel of land. And that month, he began building custom homes in Santa Ana" (Orange County Register, September 15, 1981). The parcel chosen became the Floral Park subdivision between Seventeenth Street and Santiago Creek. "When built in the 1920s, the Floral Park homes were the most lavish and expensive in the area. They sold for about \$45,000 each" (Orange County Register, September 15, 1981). Revival architecture in a wide variety of romantic styles was celebrated in the 1920s and 1930s and Floral Park showcased examples of the English Tudor, French Norman, Spanish Colonial, and Colonial Revival. The Allison Honer Construction Company went on to complete such notable projects as the 1935 Art Deco styled Old Santa Ana City Hall, the El Toro Marine Base during World War II, and the 1960 Honer Shopping Plaza. Honer lived in the neighborhood he had helped to create, at 615 West Santa Clara Avenue.*

*In the late 1920s and 1930s, another builder, Roy Roscoe Russell (1881-1965), continued developing the groves of Floral Park. An early Russell project was his 1928 subdivision of Victoria Drive between West Nineteenth Street and West Santa Clara Avenue. The homes were quite grand and displayed various revival styles, including Russell's own large, Colonial Revival mansion at 2009 Victoria Drive. In the early post World War II years, Floral Park continued its development as numerous, smaller, single-family houses were built. Continuing in the Floral Park tradition, homes in the neighborhood were mostly developed in the revival style. In the 1950s, low, horizontal Ranch Style houses completed the growth of Floral Park. Today (2022) Floral Park maintains its identity as the premier neighborhood of Santa Ana, historically home to many affluent and prominent citizens.*

*The Campbell-Jeffrey House qualifies for listing in the Santa Ana Register of Historical Properties under Criterion 1 as a representative and intact example of a Tudor Revival home. Additionally, the house has been categorized as "Contributive" because it "contributes to the overall character and history" of the Floral Park neighborhood and "is a good example of period architecture," representing the Tudor Revival style in Santa Ana (Santa Ana Municipal Code, Section 30-2.2). Character-defining features of the house include its massing and composition; fairly steeply pitched roof incorporating a side-gabled body with a projecting front gable; stucco exterior enlivened by decorative half-timbering; multi-light casement windows; original entry; and tall chimney.*

**\*B12. References (continued):**

*Harris, Cyril M. American Architecture: An Illustrated Encyclopedia. New York, WW Norton, 1998.*  
*Marsh, Diann. Santa Ana. An Illustrated History. Encinitas, Heritage Publishing, 1994.*  
*McAlester, Virginia and Lee. A Field Guide to American Houses. New York: Alfred A. Knopf, 1984.*  
*National Register Bulletin 16A. "How to Complete the National Register Registration Form." Washington DC: National Register Branch, National Park Service, US Dept. of the Interior, 1991.*  
*Office of Historic Preservation. "Instructions for Recording Historical Resources." Sacramento: March 1995.*  
*Santa Ana and Orange County Directories, 1905-2017.*  
*Ancestry.com*  
*Newspapers.com (Santa Ana Register)*  
*Historic Maps, Santa Ana History Room, 1912, 1923, 1932, and 1955.*

Exhibit C

Exterior work shall be reviewed by the Historic Resources Commission and subject to the U.S. Secretary of the Interior's Standards for Rehabilitation of Historic Buildings, as follows:

1. Every reasonable effort shall be made to provide a compatible use for a property which requires minimal alteration of the building, structure, or site and its environment, or to use a property for its originally intended purpose.
2. The distinguishing original qualities or character of a building, structure or site and its environment shall not be destroyed. The removal or alteration of any historic material or distinctive architectural features should be avoided when possible.
3. All buildings, structures, and sites shall be recognized as products of their own time. Alterations that have no historical basis and which seek to create an earlier appearance shall be discouraged.
4. Changes which may have taken place in the course of time are evidence of the history and development of a building, structure, or site and its environment. These changes may have acquired significance in their own right, and this significance shall be recognized and respected.
5. Distinctive stylistic features or examples of skilled craftsmanship which characterize a building, structure, or site shall be treated with sensitivity.
6. Deteriorated architectural features shall be repaired rather than replaced, whenever possible. In the event replacement is necessary, the new material should match the material being replaced in composition, design, color, texture, and other visual qualities. Repair or replacement of missing architectural features should be based on accurate duplications of features, substantiated by historic, physical, or pictorial evidence rather than on conjectural designs or the availability of different architectural elements from the other buildings or structures.
7. The surface cleaning of structures shall be undertaken with the gentlest means possible. Sandblasting and other cleaning methods that will damage the historic building materials shall not be undertaken.
8. Every reasonable effort shall be made to protect and reserve archaeological resources affected by, or adjacent to any project.
9. Contemporary design for alterations and additions to existing properties shall not be discouraged when such alterations and additions do not destroy significant historical, architectural or cultural material, and such design is compatible with

size, scale, color, material and character of the property, neighborhood, or environment.

10. Wherever possible, new additions or alterations to structures shall be done in such a manner that if such additions or alterations need to be removed in the future, the essential form and integrity of the structure would be unimpaired.